

Log in

1. Go to the UNLOCK Moodle website: <https://open.ktu.edu/unlock/>
2. From the upper-right of the page, click on the **Login** link.

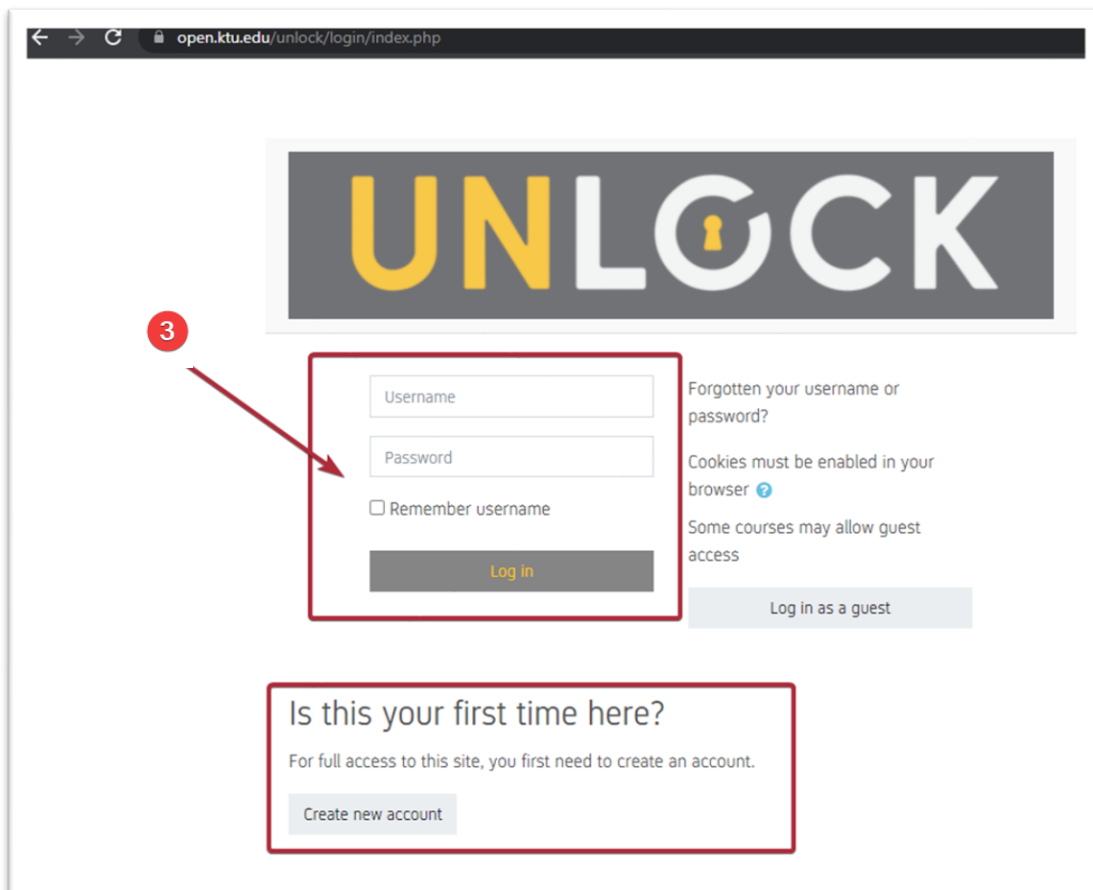

3. Log in with your username and password. (If you log in first time, you first need to create an account. Click to button *Create new account*).



Enrolling on a MOODLE course

4. After you log click the course by country tab to enter the course.

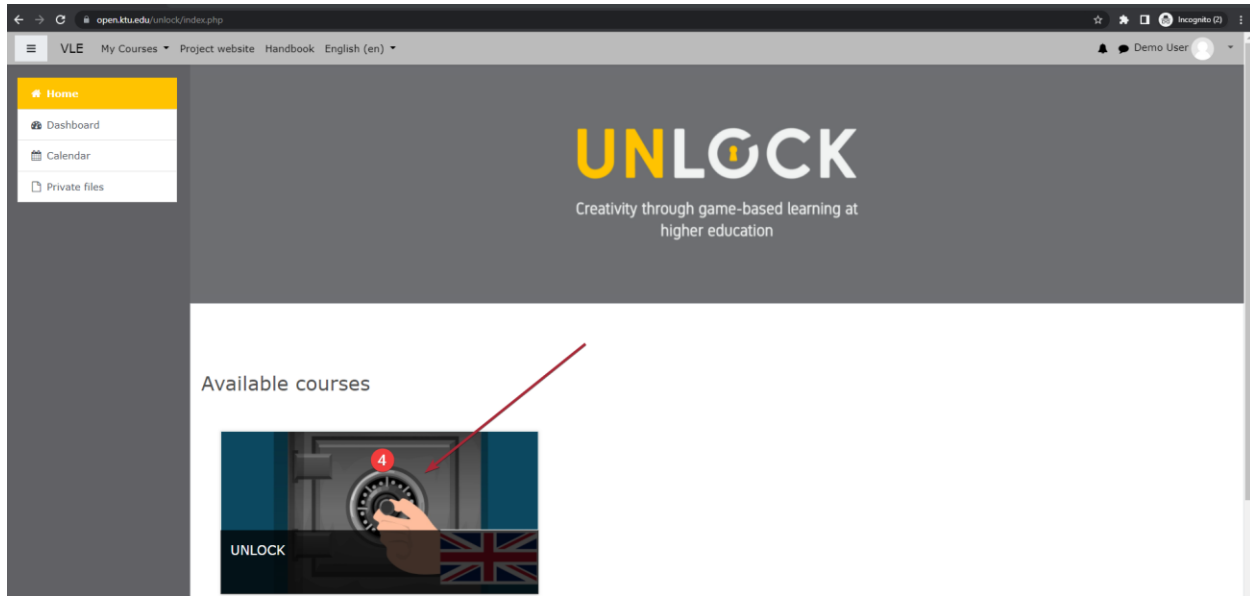

5. You will have to do a task to get the access key to the MOOC. Enter the key you received after the completion of the task.
6. **Enrolling on a Moodle course.**
 - Enter the key and click button *Enroll me*.

